

## BROKERAGE • DEVELOPMENT • INVESTMENTS

### 2854 Wade Hampton Boulevard Taylors, SC 29687

<b>Property Type</b>	Office, Retail, Warehouse/Flex
<b>Status</b>	For Lease
<b>Lease Rate</b>	\$11.00/SF plus CAM of \$2.12/SF
<b>Square Feet</b>	+/- 5,000 Square Feet
<b>Zoning</b>	C-2
<b>County</b>	Greenville
<b>Tax Map</b>	P015060402500



#### AGENT CONTACT



GARY KIRBY

[gary@kdsproperties.com](mailto:gary@kdsproperties.com)

O: 864-242-4200

M: 864-650-5556

#### PROPERTY FEATURES

- +/- 15,000 SF of Flex, Retail, or Office Space, including End Cap
- Ample Parking and Yard Storage Available
- Suites Available from 1,400 to 5,000 SF
- Monument Signage Available fronting Wade Hampton Boulevard
- High Traffic Count: 32,100 VPD with Signalized Intersection
- Located near national retailers WalMart, Publix, Aldi, Chick-Fil-A and AutoZone

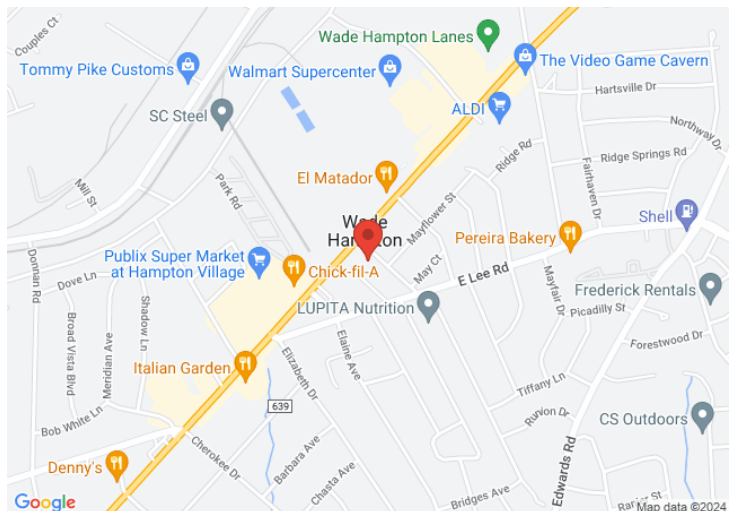

*All information contained herein has been obtained from sources deemed reliable, but we cannot guarantee it. It is also subject to change without notice.*

340 Rocky Slope Road, Suite 302, Greenville, SC 29607

📞 864-242-4200 • [kdsproperties.com](http://kdsproperties.com) • ✉ [admin@kdsproperties.com](mailto:admin@kdsproperties.com)

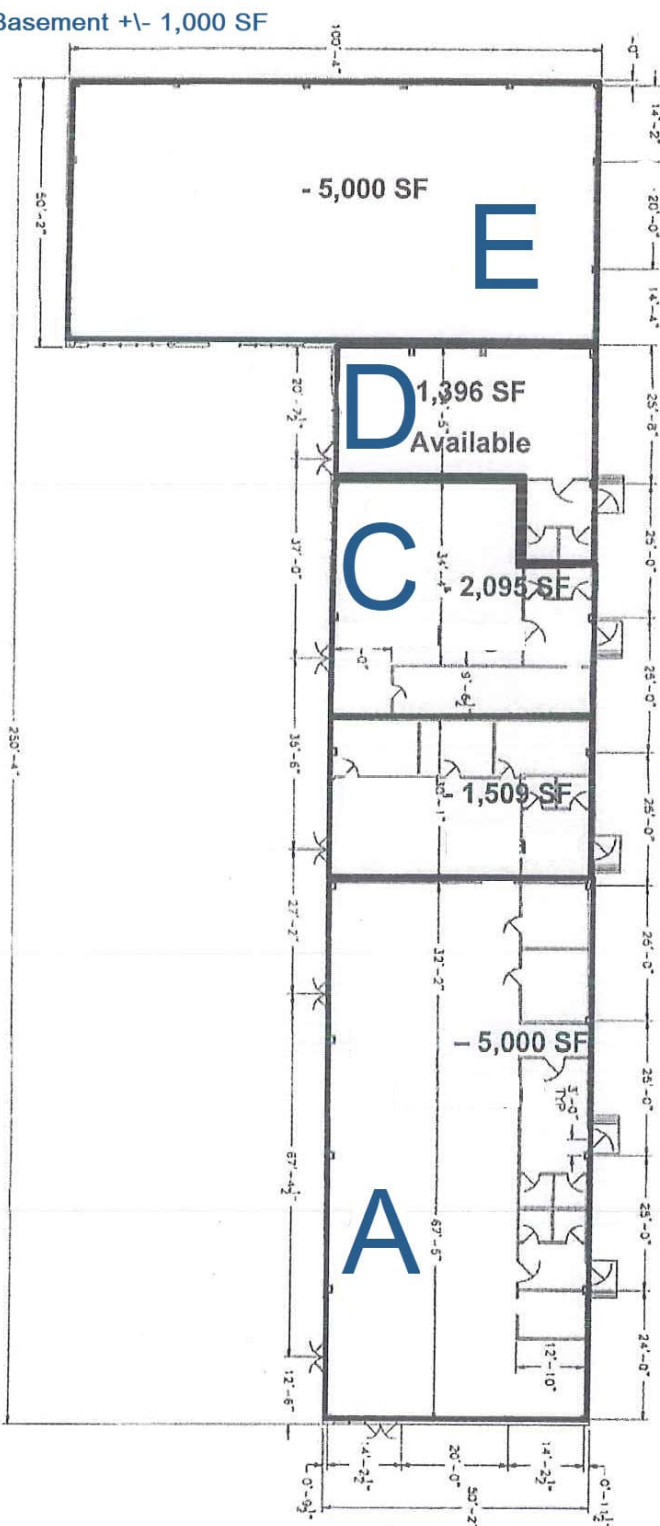

*All information contained herein has been obtained from sources deemed reliable, but we cannot guarantee it. It is also subject to change without notice.*

340 Rocky Slope Road, Suite 302, Greenville, SC 29607

📞 864-242-4200 • [kdsproperties.com](https://kdsproperties.com) • ✉ [admin@kdsproperties.com](mailto:admin@kdsproperties.com)